

Lap siding

exterior

for
people
who
create



Delivery Programme

Please choose the decors of the lap siding panels from the current Max Exterior collection. Further information of the valid stock programme of the lap siding panels you may find in our website at www.fundermax.at

Format of the standardpanel	4100 x 250 mm
Minimum quantity = 1 Packing unit = 7 Panels (or multiple of a unit)	7,175 m ²
Thickness	6 mm
Surface covered/packing unit	6,46 m ²
Surface covered/standard panel	0.92 m ²
Mounting clips (about 12 -15 pcs/m ²)	100 Klammern/VE
Vertical backing profile; length = 246 mm	10 Stk/VE
Vertical backing profile; length = 2500 mm	10 Stk/VE

For attractive solutions of corners there are several aluminium profiles available.

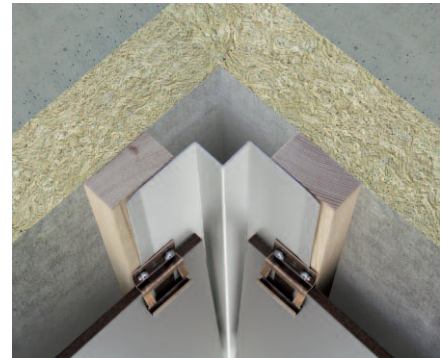
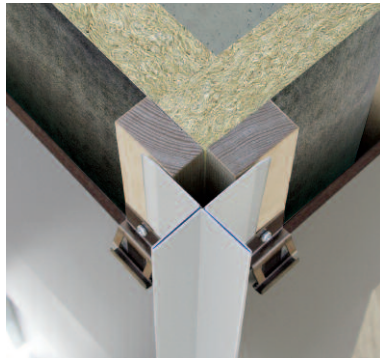
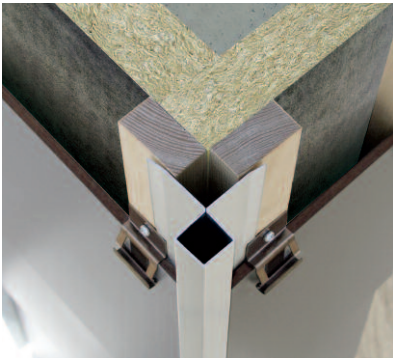

Physical Data/Properties*

Optimal lightfast	EN 438-6	grey scale ≥ 4
Fire performance	EN 13501-1	Euroclass B-s2, d0 for 6 -10 mm

*a complete list of all data and properties you will find at our website: www.fundermax.at





01 Preparing the substructure

Max Exterior lap siding elements are installed using mounting clips fixed to a substructure of vertical wooden slats. Each slat must be at least 50 mm wide for a single mounting clip, or 75 mm wide where two panels join to allow enough space for two mounting clips side-by-side. The gap between each slat should not exceed 500 mm*. The panels are installed starting from the bottom. First of all, fit a horizontal base bar (Max Exterior, 6 mm). Now fit the first row of mounting clips so they rest on the bar. Make sure you fit 2 mounting clips at each vertical joint between panels.

*The spacing specified applies to low buildings, i.e. up to 8 m in height.

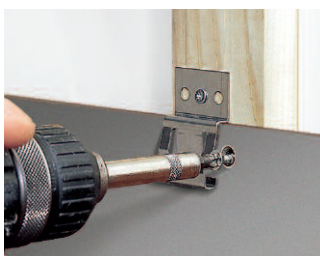

02 Installing the first row of panels

Place the groove along the lower edge of the Max Exterior lap siding elements onto the mounting clips. Secure the panels in place by fixing mounting clips along the top edge of each panel. The panel above overlaps the first row of panels by approximately 25 mm. Fit a screw next to the top middle mounting clip on each panel. This is designed to prevent the panel shifting sideways.



03 Vertical joints

A slat for fixing the mounting clips must be located at each vertical joint. Two mounting clips, one either side of the joint, are needed to provide the necessary hold. Please use backing strips to seal the vertical joint between cladding panels.

If the siding elements are arranged so the vertical joints are offset then it is sufficient to install the panel plus backing strip using a single mounting clip.

If the vertical joints are in a line then two mounting clips need to be used. There must be a gap of at least 6 mm between the panels at the joint.

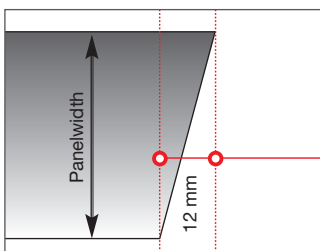
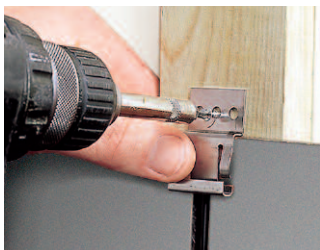

04 Outside corners/inside corners with mitre

Max Exterior lap siding elements can be mitred for both outside and inside corners.

Outside corners: The top edge of the panel must be 12 mm shorter than the lower edge of the panel (regardless of the panel width).

Inside corners: The lower edge of the panel must be 12 mm shorter than the top edge of the panel (regardless of the panel width).

The mitred edges must have a chamfer. The substructure needs to be protected with a plastic sheet to prevent water entering.



05 Installing the top row of panels

Secure the top row of panels by fitting screws along the top edge of each panel. Use screws with painted heads to match the colour of the panels, as used for the installation of full-sized Max Exterior cladding boards.

Note: Dont use countersunk-screws

Distinctive, durable, decorative – Max Exterior panels for lap siding

Surface hardness of the finest

Why take risks when you can have the doubly hardened surface? This surface makes the façade cladding extremely weather-resistant and insensitive to the sun's rays. Non-fading to perfection and scratch-proof; Max Exterior façade cladding is easy to clean and resistant against the elements. The perfect, all-round protection for façades.

The merits of an attractive system. With prefabricated Max Exterior panels for lap siding, façades are easy to

design, robust and modern, thanks to the ideal combination of a straightforward mounting system with the time-tested properties of MAX EXTERIOR façade cladding. Defy the elements.

The lap siding element bonus:

- Fast delivery for stock program
- Wide selection of decors
- Easy to mount (on wooden substructure)
- All the benefits of the Max Exterior NT surface
- Ideal board dimensions



10-9/08-312713GB.18

FUNDERMAX®

FunderMax GmbH
Klagenfurter Straße 87-89
A-9300 St. Veit/Glan

Tel.: + 43 (0) 5/9494-0
Fax: + 43 (0) 5/9494-4200
office@fundermax.at
www.fundermax.at